



Aqua Vista Square, London, E3





**Located on the bank of the canal and overlooking the park is this large light two bedroom modern apartment benefiting from 2 bathrooms and a private balcony.**



- Two Double Bedrooms
- Private Balcony
- Furnished
- City Views
- Two Bathrooms
- Available 20th June
- Overlooking Canal
- Close to Transport and Canary Wharf

Located Canalside is this impressive two bedroom, two bathroom apartment benefitting from a private balcony with far reach views over parkland and Canary Wharf .

The property comprises of two double bedrooms offering light throughout, two modern fitted bathrooms, complimented by a open plan living and kitchen area which is fully fitted. A private balcony offers views over the canal and over parkland to Canary Wharf, the location gives access to local amenities and transport and the property offers chic urban living.







## Craig Tower, Aqua Vista Square, E3

Approx. Gross Internal Area 823 Sq Ft - 76.46 Sq M  
Approx. Gross Balcony Area 129 Sq Ft - 11.98 Sq M

BUTLER & STAG

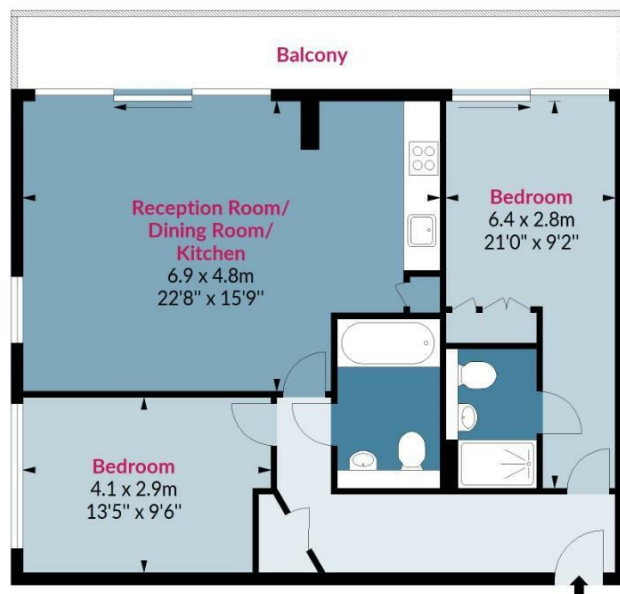

### Third Floor

Floor Area 823 Sq Ft - 76.46 Sq M



Measured according to RICS IPMS2. Floor plan is for illustrative purposes only and is not to scale. Every attempt has been made to ensure the accuracy of the floor plan shown, however all measurements, fixtures, fittings and data shown are an approximate interpretation for illustrative purposes only. 1 sq m = 10.76 sq feet.

lpaplus.com

Date: 13/6/2023

IMPORTANT NOTICE - These particulars have been prepared in good faith and they are not intended to constitute part of an offer or contract. We have not performed a structural survey on this property and the services, appliances and specific fittings have not been tested. All photographs, measurements, floor plans and distances referred to are given as a guide and should not be relied upon.

BUTLER & STAG

☎ 020 8102 1236

🏠 508 Roman Road, Bow, London, E3 5LU

✉ bow@butlerandstag.com

www.butlerandstag.uk